

PRINT A TOILET CARD HOLDER!

STEP 1: PRINT OUT THIS PAGE ON LETTER-SIZED PAPER

STEP 2: CUT OUT THE ART BELOW

STEP 3: FOLD ALONG LINES AND GLUE ALONG THE DASHED LINES

STEP 4: TAKE A PICTURE AND TAG US OR USE THE HASHTAG

#POOPCRAFTS

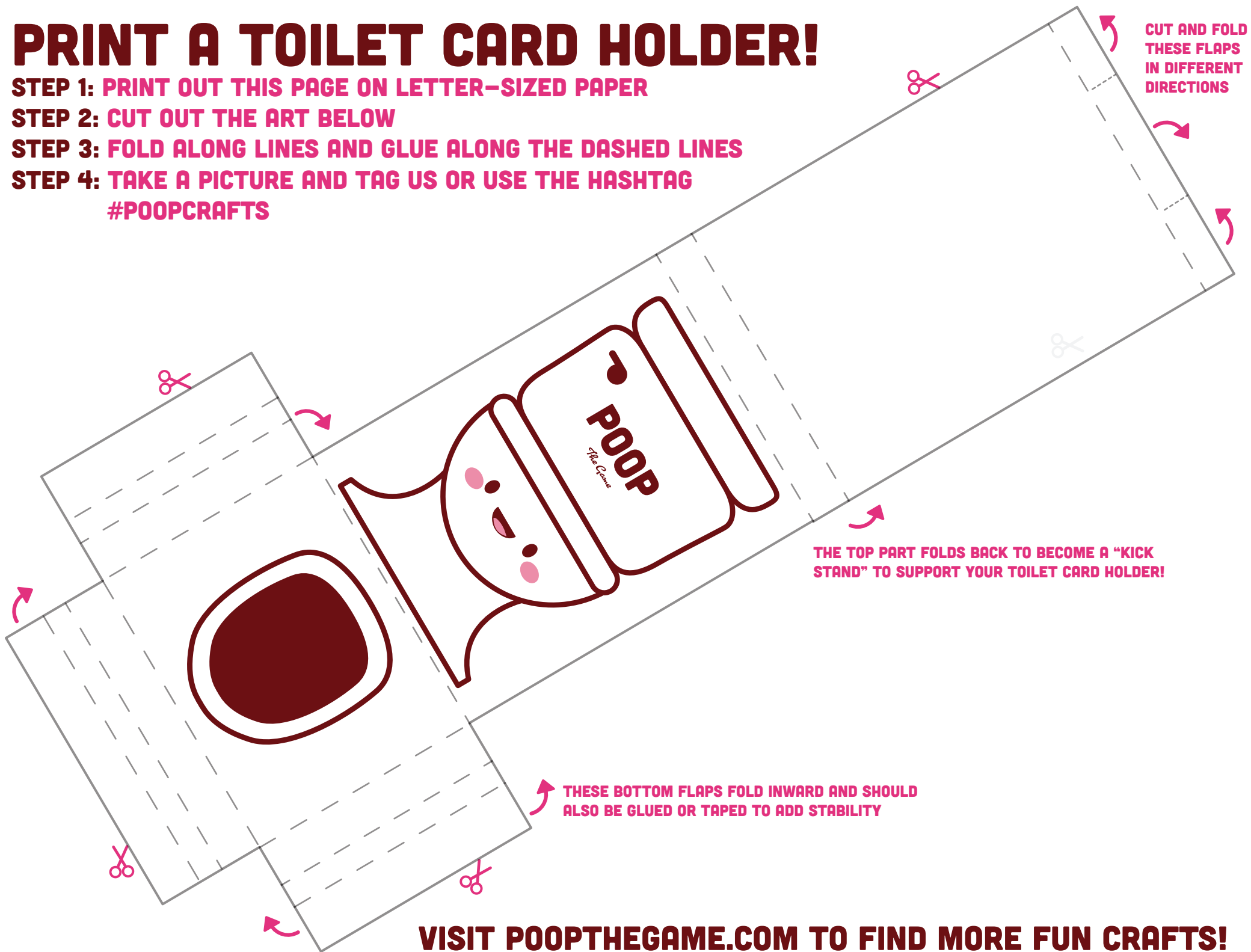

CUT AND FOLD THESE FLAPS IN DIFFERENT DIRECTIONS

THE TOP PART FOLDS BACK TO BECOME A "KICK STAND" TO SUPPORT YOUR TOILET CARD HOLDER!

THESE BOTTOM FLAPS FOLD INWARD AND SHOULD ALSO BE GLUED OR TAPED TO ADD STABILITY

VISIT POOPTHEGAME.COM TO FIND MORE FUN CRAFTS!